



Wirtschaftliche Preise
dank Roboterproduktion.



Staketengeländer

Stossdetail

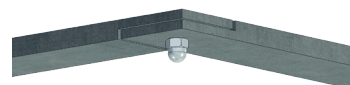
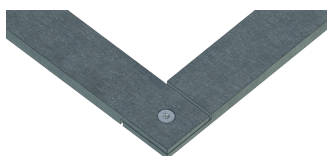
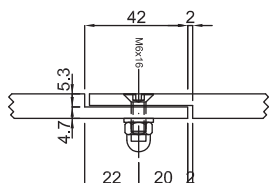

Typ G1

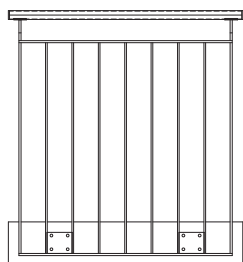

Typ G2

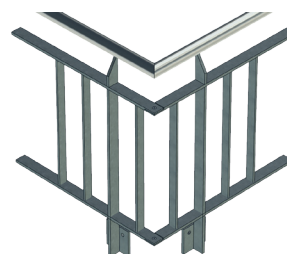
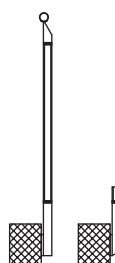
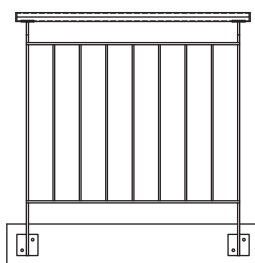

Typ G3

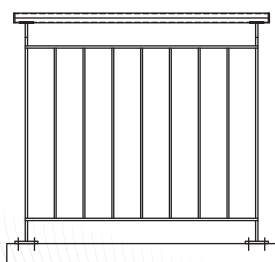

Typ G4

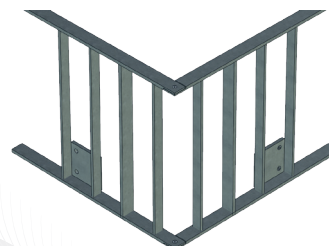
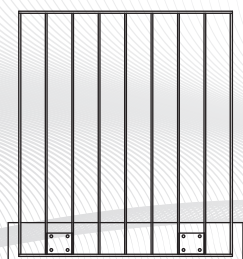

Spiess Metall- und Torbau AG

Stutz 2 | 3700 Spiez | Telefon +41 (0)33 676 01 01 | Telefax +41 (0)33 676 03 03
Mail: info@spiessmetall.ch | Internet: spiessmetall.ch

Typ G5

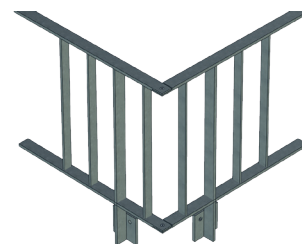
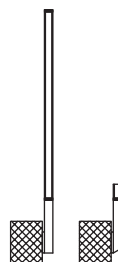
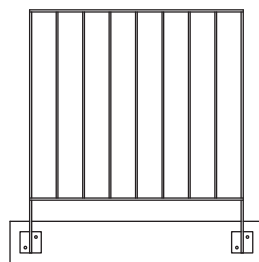

Typ G6

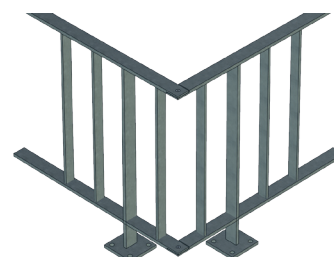
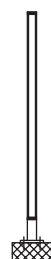
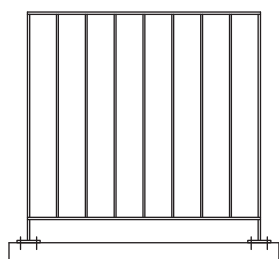

Typ G7

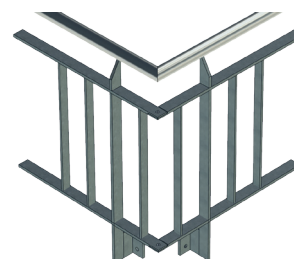
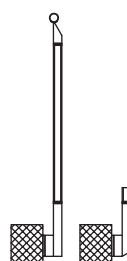
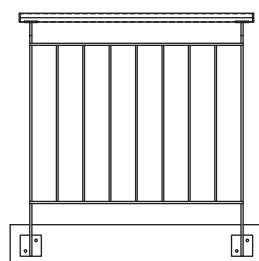

Typ G8

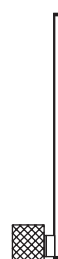
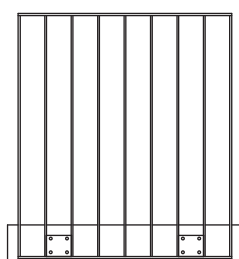

Typ G9

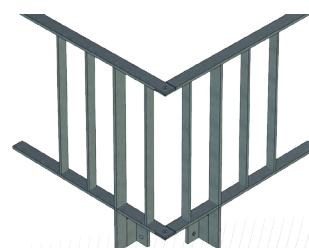
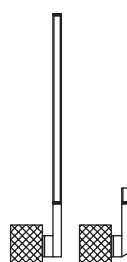
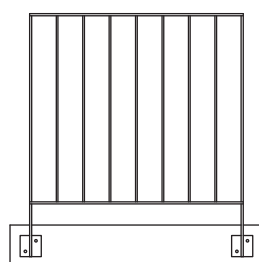

Typ G10

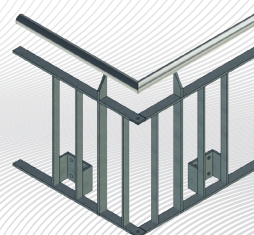
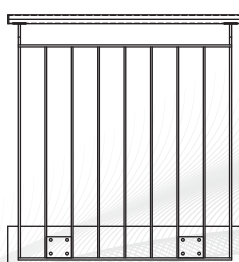

Spiess Metall- und Torbau AG

Stutz 2 | 3700 Spiez | Telefon +41 (0)33 676 01 01 | Telefax +41 (0)33 676 03 03

Mail: info@spiessmetall.ch | Internet: spiessmetall.ch