

POWERLIFT UP I [Standaid Hoist]

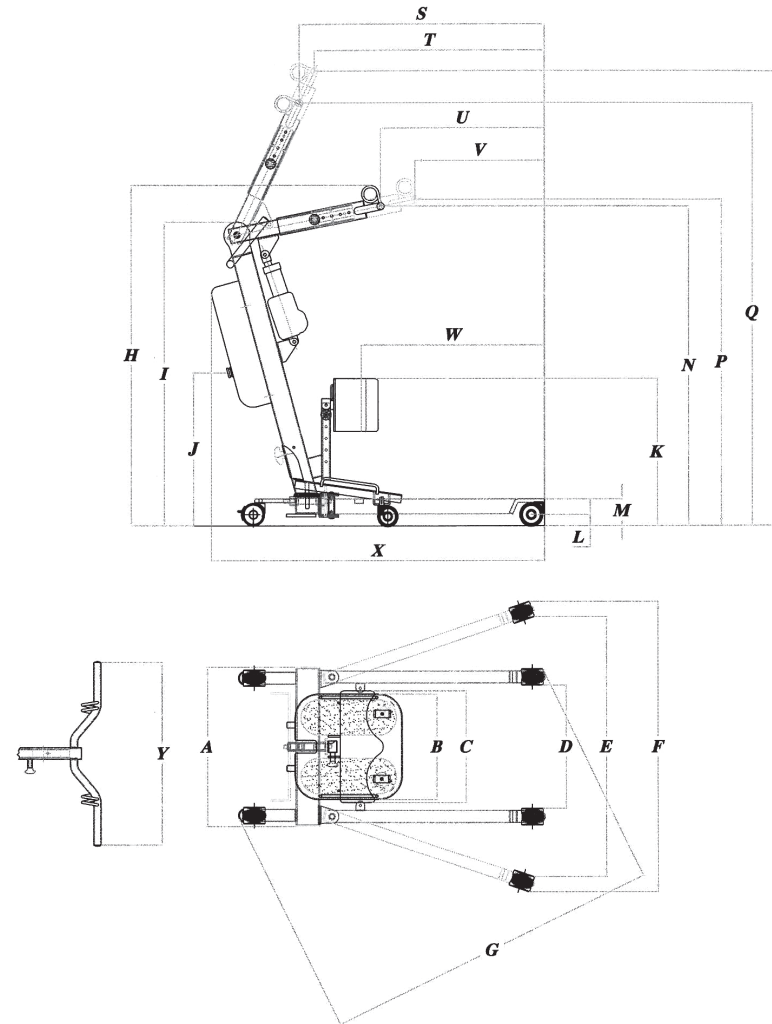

DETAILS

-  **MAXIMUM LOAD**
200 kg
-  **HEIGHT MIN / MAX:**
114 cm / 158 cm
-  **LENGTH:**
113 cm
-  **SLING INCLUDED**

MEASURES APROX. (CM)

A	54	M	10
B	36	N	108
C	38	P	109
D	43	Q	147
E	90	R	158
F	99	S	88
G	114	T	83,5
H	114	U	55
I	104	V	43
J	51	W	64
K	50-66	X	113
L	4	Y	62,5

FEATURES

- » Maximum load capacity 200 kg (included sling).
- » Height 114 -158 cm.
- » Reguable arm, five positions
- » Mast design that keeps liquids from getting inside the structure.
- » Hoist's weight: 40 kg.
- » Easy to transport and store.
- » Epoxy-polyester coated steel structure.
- » Handcontrol with magnet.
- » Removable motor.
- » LCD screen with battery indicator.
- » Audible low level battery alarm.
- » Control box with emergency stop button.
- » Possibility to use the hoist with box control
- » Check the charges through USB connexion
- » Electronic parts meet EN-60601-1 and EN-60601-1.2 standard.
- » Electric protection IPX4.

POWERLIFT UP II [Standaid Hoist]

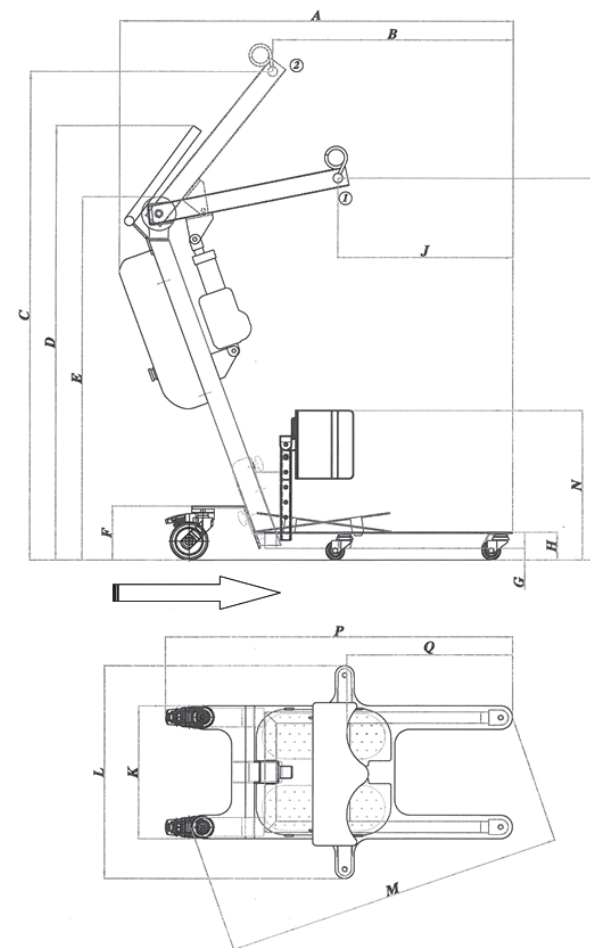

DETAILS

-  **MAXIMUM LOAD**
160kg
-  **HEIGHT MIN / MAX:**
102.5 cm / 138 cm
-  **LENGTH:**
104.5cm
-  **SLING INCLUDED**

MEASURES APROX. (CM)

A	104.5	I	102.5
B	78.5	J	47.5
C	138	K	35
D	106	L	56.5
E	97.5	M	89.5
F	15	N	41/57
G	4	P	92
H	8	Q	48

FEATURES

- » Maximum load capacity 160 kg (included sling).
- » Height 102.5 -138 cm.
- » Mast design that keeps liquids from getting inside the structure.
- » Epoxy-polyester coated steel structure.
- » Hoist's weight: 34 kg.
- » Easy to transport and store.
- » Foot rest with three positions
- » Handcontrol with magnet.
- » Removable motor.
- » LCD screen with battery indicator.
- » Audible low level battery alarm.
- » Control box with emergency stop button.
- » Possibility to use the hoist with box control
- » Check the charges through USB connexion
- » Electronic parts meet EN-60601-1 and EN-60601-1.2 standard.
- » Electric protection IPX4.